

MODULAR 800



800



Powerful and fast fogging system, can cover up to **2400 m³ in 64 seconds** (800 m³ visibility less than 1 m)

GENERAL SPECIFICATIONS

Compact Cabinet	yes
Weight of the fogging system	9,5 KG
Overall packaging weight	10,5 KG
Units on 100×120 cm pallet	36
Dimensions of the fogging system	30 x13 xH39
Size of the packaging	36 x19 xH45
Colors	white / black opt.
Operating time without mains power	over 1 hour
Heating time	about 2 hours
Vertical mounting	yes
Horizontal mounting	yes
Usb port for computer monitoring (Windows and Linux)	yes
Serial bus for standard UR FOG protocol	yes
Alarm kit	optional

ELECTRICAL SPECIFICATIONS

Mains power	230 V or 120 V
Average consumption	48 W
Heater max power in start	280 W
Backup battery (not included)	yes

FOGGING SYSTEM

New "layer" heating system	yes
Single shot coverage (visibility more than 1,5 m)	2400 m ³
Single shot coverage (visibility less than 1 m)	800 m ³
Maximum emission time in a single shot	64 sec
Total discharge capability with full bag	2400 m ³
Number of bags	1
Amount of fluid in the bag	1000 ml
Shot characteristics	programmable in sec.
Number of bags included	1
2 cabled inputs: arming and shooting	yes
1 cabled output: fault (empty bag, low battery/lack of power supply, system failure)	yes
Serial interface RS232	yes
Standard communication protocol	yes
Top internal riser for optional boards	no
Side internal riser optional boards	yes
Front panel made of plastic material to simplify wireless communication	yes

STANDARD

CE certification	yes
Certified fog fluid	yes
Compliant to the current europeans regulations	yes

Accessories and refills MODULAR 800

CODE	ACCESSORIES AND REFILLS	MODULAR 800
FFLXTRC8	Fluid bag 1000 ml	■
FFLXTRC8FG	Fluid bag 1000 ml Food Grade	■
FPUSRCP	Side riser	■
FPUSTD	Desk stand	■
FPUWB	Orientable wakll bracket	■
F23KITDM	Demo Kit: modular (key+keyfob/receiver)	■
URCLWF	Active Cloud Lan / WIFI board	■
URCLWFA	Wifi antenna module	■
URCLWFM	Mounting Kit Modular (cable 12V + flat cable Modular)	■



ACTIVE CLOUD

Active Cloud LAN / Wifi board

The WIFI LAN board allows wired or wireless Lan connection. Through the extremely secure Cloud service, provided for free, it allows, in addition to system monitoring, to remotely arm, shoot and set shooting time of the fogging system.



It is very easy to change and with a very competitive price.

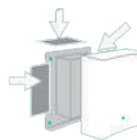

It is possible to add optional boards inside the cabinet, such as alarm centrals, sensors, etc.



A unique serial bus to plug on the electronic board an add on card that allows to interface easily the machine with alarms and to control the fogging system even from remote locations. A standard protocol is available for all machines.



Thanks to the massive insulation UR FOG fogging systems have a very low power consumption and can shoot for a long time in absence of mains power; temperature remains stable over time.

Long lasting operation time without mains

The innovative thermal insulation of the heater allows UR Fog systems to work for a long period of time without mains power: over 1 h !

Electronic board



Connection PIN description

DC12V Power supply OUTPUT

1 +	DC 12V Output (max 300 mA)
2 -	GND

OUTPUTS

3 READY	OC - temperature reached
4 ARM	OC - ready to shoot
5 EMPTY/FAULT	OC - empty bag/faulty unit

INPUTS

6 -	GND
7 ARM	Arming input
8 TRIG	Shooting input

Note: both commands are contacts that close towards GND

Power supply
to control
the electronic
board and pump



“Layer”
technology heating

Optional 2Ah battery
to power the electronic
board and pump in case
of mains power absence

FOG STORM PUMP

Specially designed to work with high-glycol percentage fluids



Example internal alarm station mounting

